

# WORLD OLIVET ASSEMBLY

LOCATION OF SITE:  
115 DOVER FURNACE ROAD  
TOWN OF DOVER  
DUTCHESS COUNTY, NEW YORK STATE

SCALE: 1"=2000'  
PLAN REFERENCE: DOVER PLAINS USGS QUADRANGLE

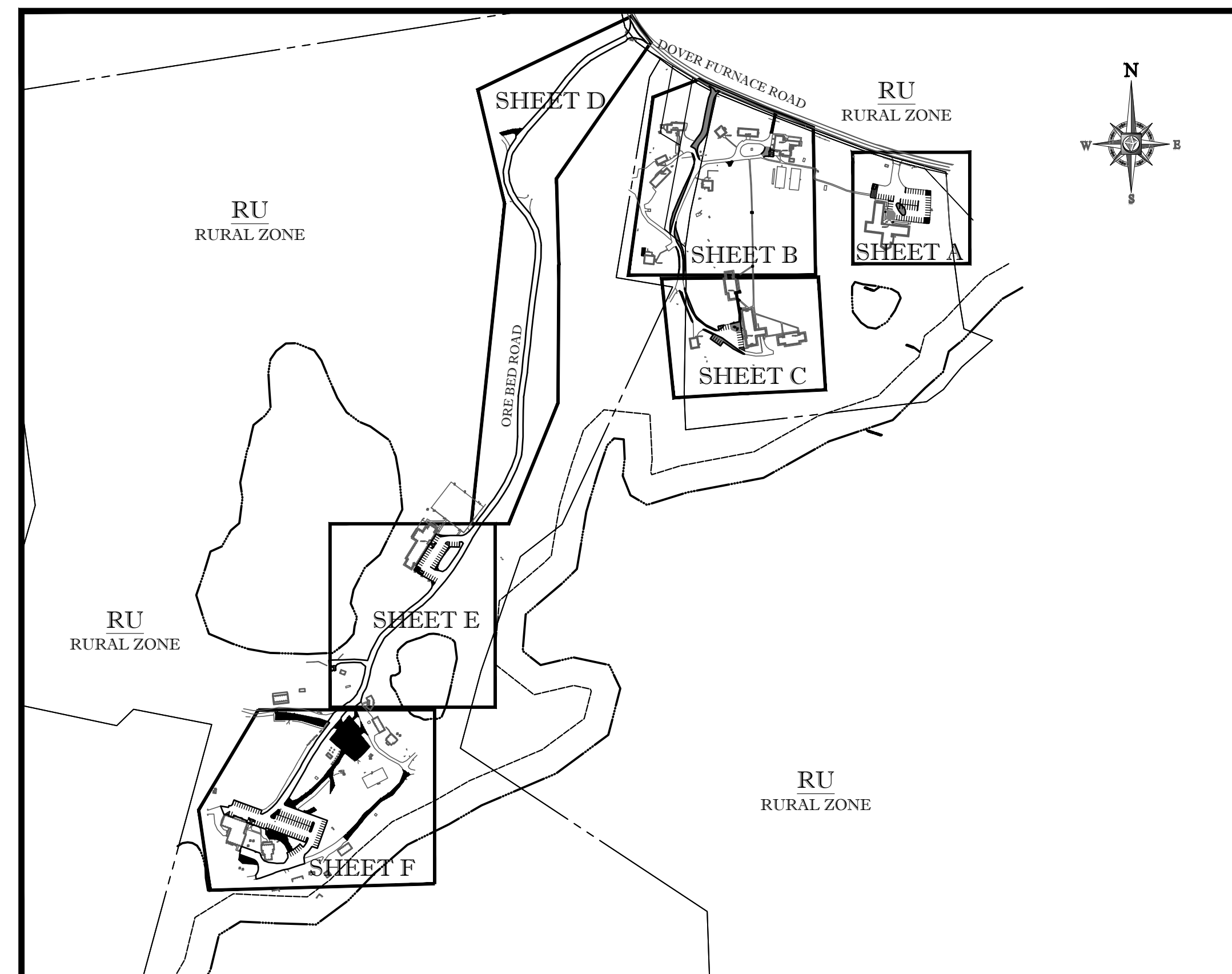

SCALE: 1"=400'

[illegible]

SHEET INDEX

ANY PERSON IS PROHIBITED FROM ALTERING ANYTHING ON THESE DRAWINGS AND/OR THE ACCOMPANYING SPECIFICATIONS, UNLESS IT IS UNDER THE WRITTEN DIRECTION OF A LICENSED PROFESSIONAL ENGINEER OF THE FIRM. IN THE EVENT SUCH ALTERATIONS ARE MADE, THE PROFESSIONAL ENGINEER OF THE FIRM MUST SIGN, SEAL, DATE, AND DESCRIBE THE FULL EXTENT OF THE ALTERATION ON THE DRAWINGS AND/OR IN THE SPECIFICATIONS. (NYS EDUCATION LAW SECTION 7209-2)



# BOHLER

## ENGINEERING

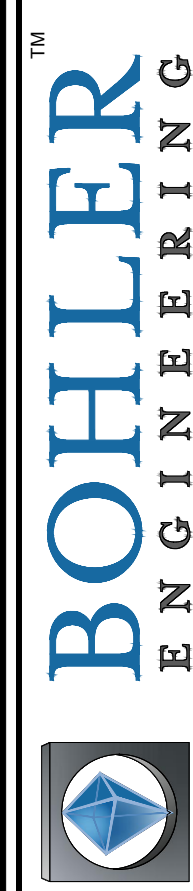
[illegible]

REV	DATE	COMMENT	B
1			
2			
3			
4			
5			
6			
7			
8			
9			
10			
11			
12			
13			
14			
15			

PROJECT No.:	B190164SS00
DRAWN BY:	JSS
CHECKED BY:	SRD
DATE:	6/12/2010
SCALE:	AS NOTE
CAD I.D.:	B190164SS00(USE THIS)

WORLD OLIVET  
ASSEMBLY

LOCATION OF SITE  
115 DOVER FURNACE ROAD  
TOWN OF DOVER  
DUTCHESS COUNTY  
STATE OF NEW YORK



17 COMPUTER DRIVE WEST  
ALBANY, NY 12205  
Phone: (518) 438-9900

[www.BohlerEngineering.com](http://www.BohlerEngineering.com)

W.D. GOEBEL

**PROFESSIONAL ENGINEER**  
MASSACHUSETTS LICENSE No. 42644-C  
RHODE ISLAND LICENSE No. 7268  
CONNECTICUT LICENSE No. 21854  
NEW HAMPSHIRE LICENSE No. 10280  
MAINE LICENSE No. 9490  
NEW YORK LICENSE No. 071284-1  
FLORIDA LICENSE No. 66202

SHEET TITLE:

## SHEET NUMBER: \_\_\_\_\_

1  
OF 7

REV 0



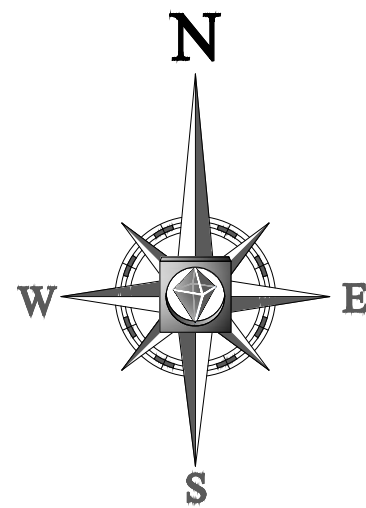

LAND USE / ZONING INFORMATION & NOTES

- 1. APPLICANT:  
WORLD OLIVET ASSEMBLY  
115 DOVER FURNACE ROAD  
DOVER PLAINS, NY 12522
- 2. OWNER:  
WORLD OLIVET ASSEMBLY  
115 DOVER FURNACE ROAD  
DOVER, NY 12522
- 3. PARCEL:  
NYS GRID NUMBER: 132600-7061-00-357420-0000, 132600-7061-00-162280-0000  
115 DOVER FURNACE ROAD  
TOWN OF DOVER  
DUTCHESS COUNTY, NEW YORK STATE

ZONING ANALYSIS TABLE			
ZONING DISTRICT	RU RURAL DISTRICT		
ZONE CRITERIA	REQUIRED	EXISTING	PROPOSED
MINIMUM LOT AREA	2 ACRES	210 + ACRES	UNCHANGED
MINIMUM LOT FRONTAGE	300'	1,300'+	UNCHANGED
MIN. FRONT SETBACK	60'	59.5'	UNCHANGED
MIN. SIDE SETBACK	30'	144'	UNCHANGED
MIN. REAR SETBACK	50'	250'+	UNCHANGED
MAX. BUILDING HEIGHT	35'	28'	UNCHANGED
MAX. IMPERVIOUS COVERAGE	10%	3.6%	UNCHANGED

PARKING ANALYSIS TABLE		
BUILDING NUMBER	REQUIRED	PROVIDED
1	34	56

BOHLER  
ENGINEERING

SITE CIVIL AND CONSULTING ENGINEERING  
LAND SURVEYING DESIGN  
SUSTAINABLE DESIGN

PERMITTING SERVICES  
TRANSPORTATION SERVICES

CHARLOTTE, NC  
ATLANTA, GA  
BALTIMORE, MD  
BIRMINGHAM, AL  
CHICAGO, IL  
CINCINNATI, OH  
COLUMBIA, SC  
DENVER, CO  
FORT LAUDERDALE, FL  
HOUSTON, TX  
INDIANAPOLIS, IN  
JACKSONVILLE, FL  
KANSAS CITY, MO  
LONG BEACH, CA  
LOS ANGELES, CA  
MEMPHIS, TN  
MIAMI, FL  
MINNEAPOLIS, MN  
NEW YORK, NY  
PHILADELPHIA, PA  
PORTLAND, ME  
SAN ANTONIO, TX  
SAN JOSE, CA  
SEATTLE, WA  
SPRINGFIELD, IL  
TAMPA, FL  
TULSA, OK  
WASHINGTON, DC  
WICHITA, KS  
WILSON, NC

REVISIONS			
REV	DATE	COMMENT	BY
1			
2			
3			
4			
5			
6			
7			
8			
9			
10			
11			
12			
13			
14			
15			

PERMIT  
SET

PROJECT No.: B190164

DRAWN BY: JSH

CHECKED BY: SRW

DATE: 6/12/2019

SCALE: AS NOTED

CAD I.D.: B190164SS00(USE THIS)

PROJECT: SITE  
IMPROVEMENT  
PLANS  
FOR  
WORLD OLIVET  
ASSEMBLY

LOCATION OF SITE  
115 DOVER FURNACE ROAD  
TOWN OF DOVER  
DUTCHESS COUNTY  
STATE OF NEW YORK

BOHLER  
ENGINEERING

17 COMPUTER DRIVE WEST  
ALBANY, NY 12205  
Phone: (518) 438-9900

www.BohlerEngineering.com

W.D. GOEBEL

PROFESSIONAL ENGINEER  
MASSACHUSETTS LICENSE No. 42644-C  
RHODE ISLAND LICENSE No. 7269  
CONNECTICUT LICENSE No. 21854  
NEW HAMPSHIRE LICENSE No. 10280  
MAINE LICENSE No. 9490  
NEW YORK LICENSE No. 03104-1  
FLORIDA LICENSE No. 66202

SHEET TITLE:  
PHASE 1  
SITE  
PLAN A

SHEET NUMBER:  
2  
OF 7

REV 0

P:\190164\Drawings\Plan Set\03\_CDD\_Work\NEW WORK\Phase 1 Plans\B190164SS00\USE THIS.dwg, 04/16/2014, 4:28:00 PM, jsh, jsh, Xrefs\03-1.dwg, Use\03-1.dwg



ANY PERSON IS PROHIBITED FROM ALTERING ANYTHING ON THESE DRAWINGS AND/OR THE ACCOMPANYING SPECIFICATIONS, UNLESS IT IS UNDER THE WRITTEN DIRECTION OF A LICENSED PROFESSIONAL ENGINEER OF THE FIRM. IN THE EVENT SUCH ALTERATIONS ARE MADE, THE PROFESSIONAL ENGINEER OF THE FIRM MUST SIGN, SEAL, DATE, AND DESCRIBE THE FULL EXTENT OF THE ALTERATION ON THE DRAWINGS AND/OR IN THE SPECIFICATIONS. (NYS EDUCATION LAW SECTION 7209.2)

REFER TO GENERAL NOTES  
SHEET FOR NOTES

THIS PLAN TO BE UTILIZED FOR SITE  
LAYOUT PURPOSES ONLY

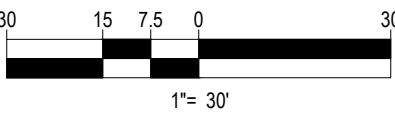





ANY PERSON IS PROHIBITED FROM ALTERING ANYTHING ON THESE DRAWINGS AND/OR THE ACCOMPANYING SPECIFICATIONS, UNLESS IT IS UNDER THE WRITTEN DIRECTION OF A LICENSED PROFESSIONAL ENGINEER OF THE FIRM. IN THE EVENT SUCH ALTERATIONS ARE MADE, THE PROFESSIONAL ENGINEER OF THE FIRM MUST SIGN, SEAL, DATE, AND DESCRIBE THE FULL EXTENT OF THE ALTERATION ON THE DRAWINGS AND/OR IN THE SPECIFICATIONS. (NYS EDUCATION LAW SECTION 7209-2)

30 15 7.5 0

1" = 30'

SHEET TITLE:

PHASE 1  
SITE  
PLAN B

SHEET NUMBER:

3  
OF 7

REV 0





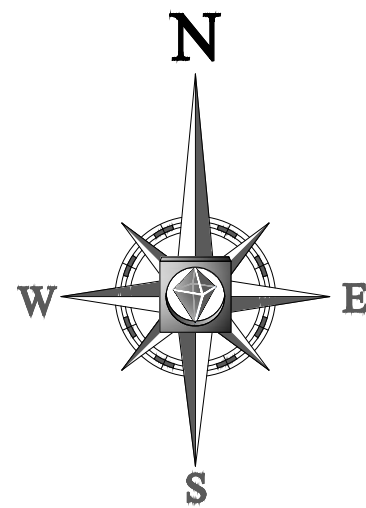

# PARKING ANALYSIS TABLE

BUILDING NUMBER	REQUIRED	PROVIDED
2	18	10
3	16	10
4	16	0
9	2	4

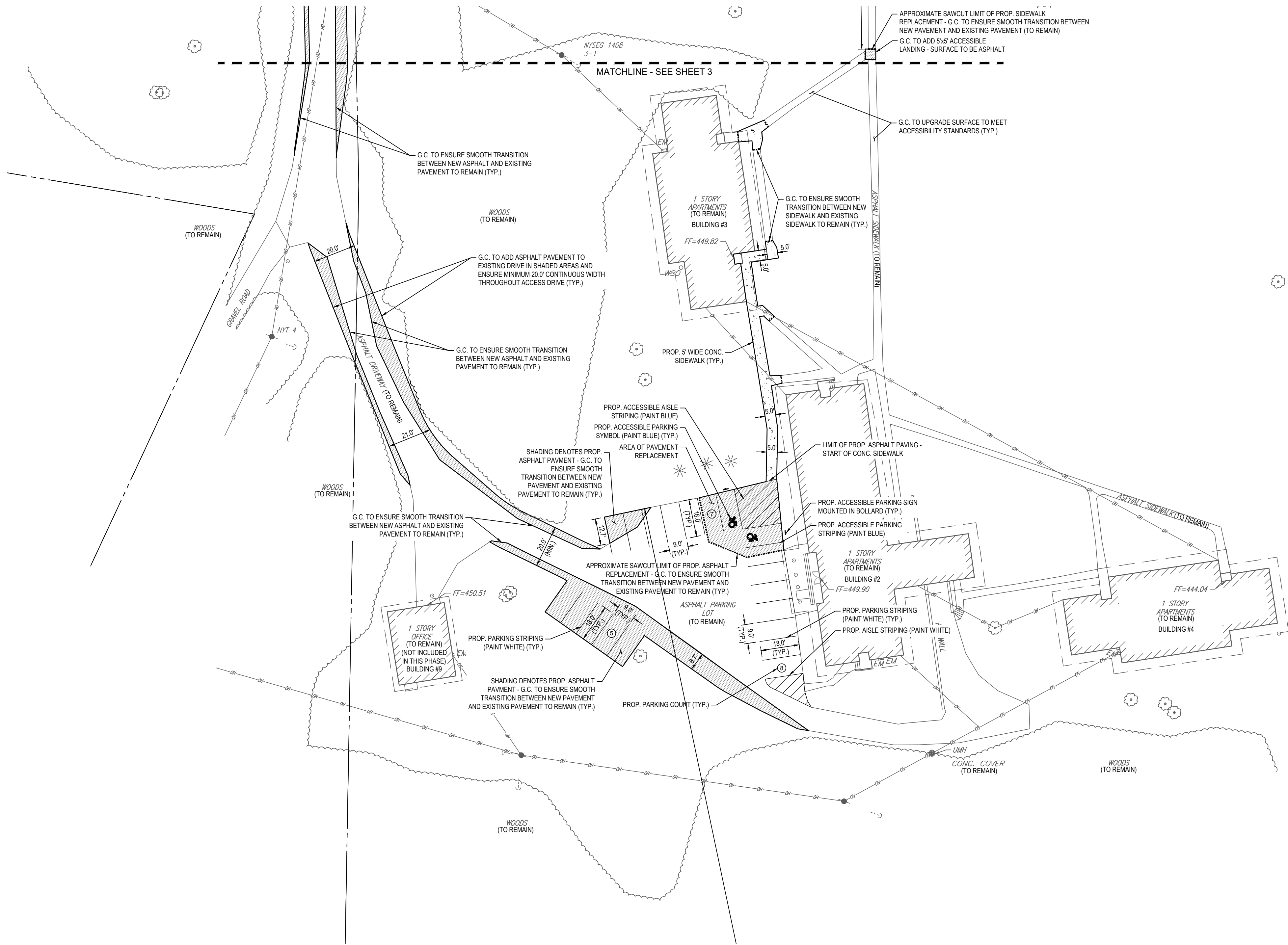

REFER TO GENERAL NOTES  
SHEET FOR NOTES

THIS PLAN TO BE UTILIZED FOR SITE  
LAYOUT PURPOSES ONLY

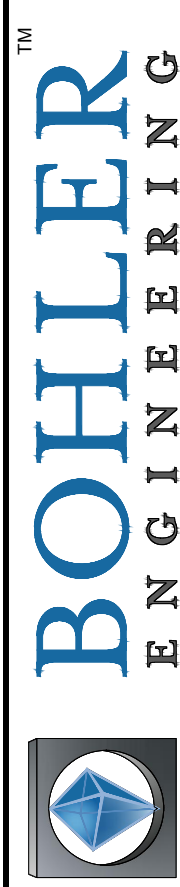
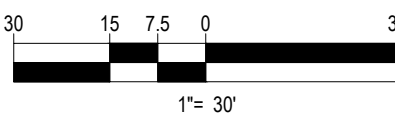

## REVISIONS

REV	DATE	COMMENT	BY
1			
2			
3			
4			
5			
6			
7			
8			
9			
10			
11			
12			
13			
14			
15			

## PERMIT SET

PROJECT No.: B190164  
DRAWN BY: JSH  
CHECKED BY: SRW  
DATE: 6/12/2019  
SCALE: AS NOTED  
CAD I.D.: B190164SS00(USE THIS)

## SITE IMPROVEMENT PLANS FOR WORLD OLIVET ASSEMBLY

LOCATION OF SITE  
115 DOVER FURNACE ROAD  
TOWN OF DOVER  
DUTCHESS COUNTY  
STATE OF NEW YORK



17 COMPUTER DRIVE WEST  
ALBANY, NY 12205  
Phone: (518) 438-9900

[www.BohlerEngineering.com](http://www.BohlerEngineering.com)

## W.D. GOEBEL

PROFESSIONAL ENGINEER  
MASSACHUSETTS LICENSE No. 42644-C  
RHODE ISLAND LICENSE No. 7269  
CONNECTICUT LICENSE No. 21854  
NEW HAMPSHIRE LICENSE No. 10290  
MAINE LICENSE No. 9490  
NEW YORK LICENSE No. 03104-1  
FLORIDA LICENSE No. 66202

SHEET TITLE:

## PHASE 1 SITE PLAN C

SHEET NUMBER:

4  
OF 7

REV 0



Know what's below.  
Call before you dig.

ANY PERSON IS PROHIBITED FROM ALTERING ANYTHING ON THESE DRAWINGS AND/OR THE ACCOMPANYING SPECIFICATIONS, UNLESS IT IS UNDER THE WRITTEN DIRECTION OF A LICENSED PROFESSIONAL ENGINEER OF THE FIRM. IN THE EVENT SUCH ALTERATIONS ARE MADE, THE PROFESSIONAL ENGINEER OF THE FIRM MUST SIGN, SEAL, DATE, AND DESCRIBE THE FULL EXTENT OF THE ALTERATION ON THE DRAWINGS AND/OR IN THE SPECIFICATIONS. (NYS EDUCATION LAW SECTION 7209.2)









ANY PERSON IS PROHIBITED FROM ALTERING ANYTHING ON THESE DRAWINGS AND/OR THE ACCOMPANYING SPECIFICATIONS, UNLESS IT IS UNDER THE WRITTEN DIRECTION OF A LICENSED PROFESSIONAL ENGINEER OF THE FIRM. IN THE EVENT SUCH ALTERATIONS ARE MADE, THE PROFESSIONAL ENGINEER OF THE FIRM MUST SIGN, SEAL, DATE, AND DESCRIBE THE FULL EXTENT OF THE ALTERATION ON THE DRAWINGS AND/OR IN THE SPECIFICATIONS. (NYS EDUCATION LAW SECTION 7209-2)

THIS PLAN TO BE UTILIZED FOR SITE  
LAYOUT PURPOSES ONLY



**Know what's below.  
Call before you dig.**

REV	DATE	COMMENT	BY
1			
2			
3			
4			
5			
6			
7			
8			
9			
10			
11			
12			
13			
14			
15			

PROJECT No.:	B190164
DRAWN BY:	JSH
CHECKED BY:	SRW
DATE:	6/12/2019
SCALE:	AS NOTED
CAD I.D.:	B190164SS00(USE THIS)

LOCATION OF SITE  
115 DOVER FURNACE ROAD  
TOWN OF DOVER  
DUTCHESS COUNTY  
STATE OF NEW YORK



[www.BohlerEngineering.com](http://www.BohlerEngineering.com)

**PROFESSIONAL ENGINEER**  
MASSACHUSETTS LICENSE No. 42644-C  
RHODE ISLAND LICENSE No. 7268  
CONNECTICUT LICENSE No. 21854  
NEW HAMPSHIRE LICENSE No. 10280  
MAINE LICENSE No. 9490  
NEW YORK LICENSE No. 071284-1  
FLORIDA LICENSE No. 66202

**SHEET TITLE:**

## SHEET NUMBER

6  
OF 7

REV 0



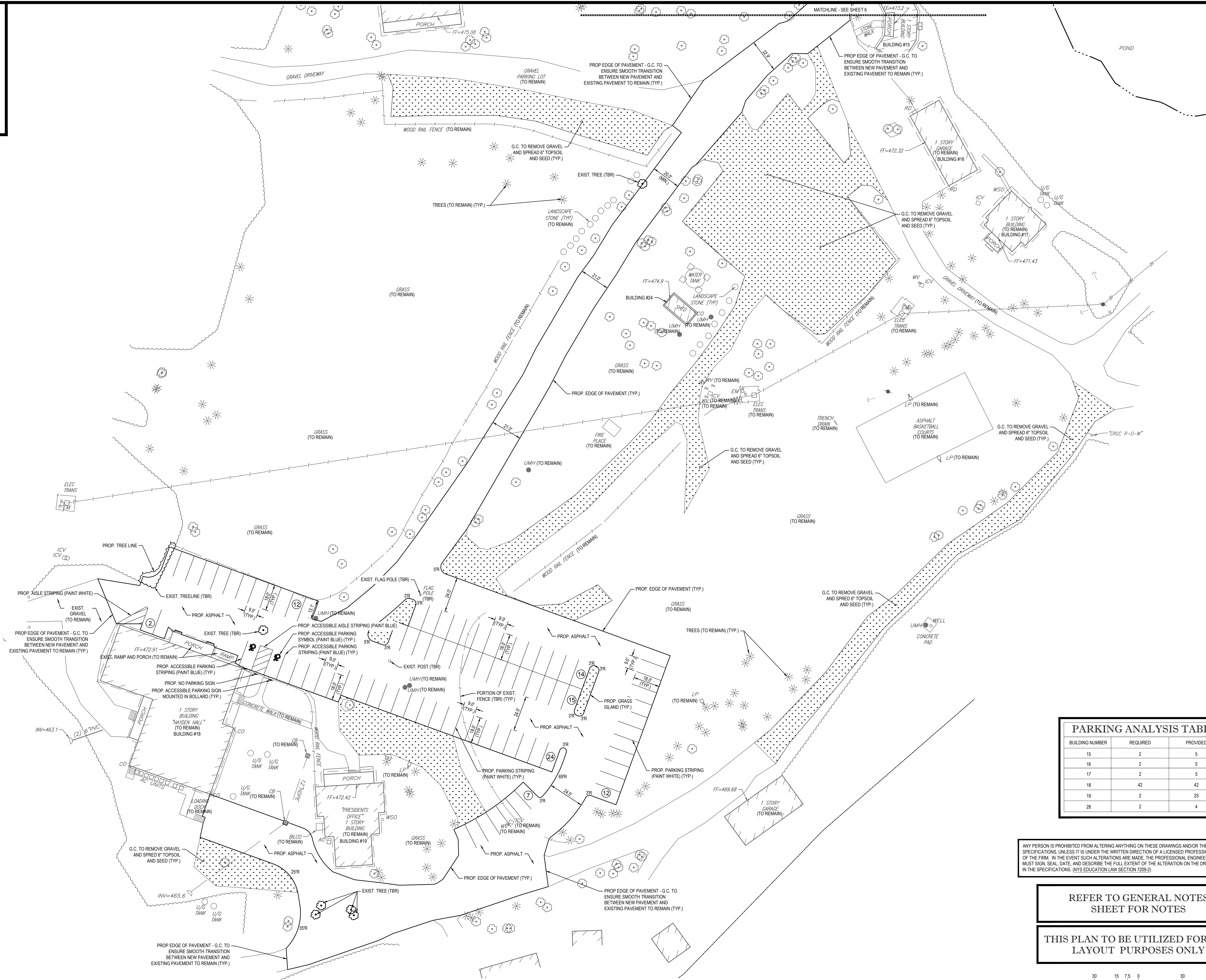
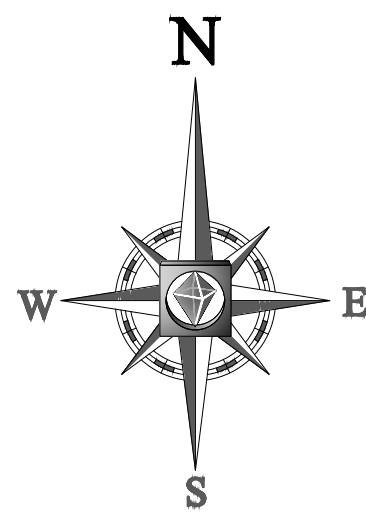

PARKING ANALYSIS TABLE		
BUILDING NUMBER	REQUIRED	PROVIDED
15	2	5
16	2	5
17	2	5
18	42	42
19	2	25
28	2	4

ANY PERSON IS PROHIBITED FROM ALTERING ANYTHING ON THESE DRAWINGS AND/OR THE ACCOMPANYING SPECIFICATIONS, UNLESS IT IS UNDER THE WRITTEN DIRECTION OF A LICENSED PROFESSIONAL ENGINEER OF THE FIRM. IN THE EVENT SUCH ALTERATIONS ARE MADE, THE PROFESSIONAL ENGINEER OF THE FIRM MUST SIGN, SEAL, DATE, AND DESCRIBE THE FULL EXTENT OF THE ALTERATION ON THE DRAWINGS AND/OR IN THE SPECIFICATIONS. (NYS EDUCATION LAW SECTION 7209.2)

REFER TO GENERAL NOTES  
SHEET FOR NOTES

THIS PLAN TO BE UTILIZED FOR SITE  
LAYOUT PURPOSES ONLY

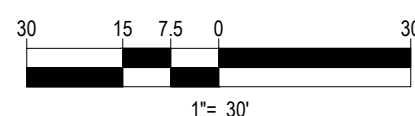

**BOHLER  
ENGINEERING**

SITE CIVIL AND CONSULTING ENGINEERING  
LAND SURVEYING DESIGN  
SUSTAINABLE DESIGN  
PERMITTING SERVICES  
TRANSPORTATION SERVICES

CHARLOTTE, NC  
ATLANTA, GA  
BALTIMORE, MD  
BOSTON, MA  
CHICAGO, IL  
CINCINNATI, OH  
COLUMBIA, SC  
DENVER, CO  
FORT LAUDERDALE, FL  
HOUSTON, TX  
INDIANAPOLIS, IN  
JACKSONVILLE, FL  
KANSAS CITY, MO  
LOS ANGELES, CA  
MEMPHIS, TN  
MIAMI, FL  
MINNEAPOLIS, MN  
NEW YORK, NY  
PHILADELPHIA, PA  
PORTLAND, ME  
SAN ANTONIO, TX  
SAN JOSE, CA  
SEATTLE, WA  
SPRINGFIELD, IL  
TAMPA, FL  
WASHINGTON, DC  
WICHITA, KS

REVISIONS			
REV	DATE	COMMENT	BY
1			
2			
3			
4			
5			
6			
7			
8			
9			
10			
11			
12			
13			
14			
15			

**PERMIT  
SET**

PROJECT No.: B190164  
DRAWN BY: JSH  
CHECKED BY: SRW  
DATE: 6/12/2019  
SCALE: AS NOTED  
CAD I.D.: B190164SS00(USE THIS)

**SITE  
IMPROVEMENT  
PLANS  
FOR**

**WORLD OLIVET  
ASSEMBLY**

LOCATION OF SITE  
115 DOVER FURNACE ROAD  
TOWN OF DOVER  
DUTCHESS COUNTY  
STATE OF NEW YORK

**BOHLER  
ENGINEERING**

17 COMPUTER DRIVE WEST  
ALBANY, NY 12205  
Phone: (518) 438-9900  
[www.BohlerEngineering.com](http://www.BohlerEngineering.com)

**W.D. GOEBEL**

PROFESSIONAL ENGINEER  
MASSACHUSETTS LICENSE No. 42844-C  
RHODE ISLAND LICENSE No. 7289  
CONNECTICUT LICENSE No. 21854  
NEW HAMPSHIRE LICENSE No. 10280  
MAINE LICENSE No. 9490  
NEW YORK LICENSE No. 03104-1  
FLORIDA LICENSE No. 66202

SHEET TITLE:  
**PHASE 1  
SITE  
PLAN F**

SHEET NUMBER:  
**7**  
OF 7

REV 0

P:\190164\Drawings\Plan Set\03\_CDD\_Work\NEW WORX\Phase 1 Plans\B190164SS00(USE THIS).dwg, 04-Site (7), 10/06/2014, 4:26:00 PM, jsherman, Xpco\510-1.pcd, User\3A, 1:1